

ESCALATOR STEP-CHAINS

FAHRTREPPENKETTEN

**Passenger
conveyor chains**
Ketten für Fahrsteige

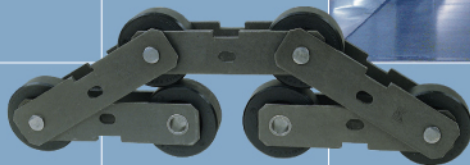

Escalator step-chains
Ketten für Fahrtreppen

Escalator step-chains Fahrtreppenketten

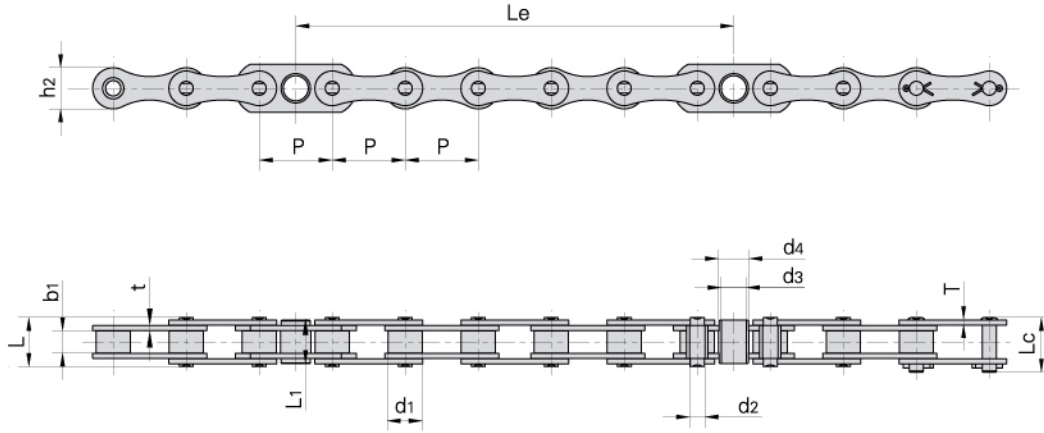

Donghua Chain No. Donghua Ketten Nr.	Pitch	Roller diameter	Width between inner plates	Pin diameter	Pin length		Bush diameter		Bush length		Plate dimension		Distance between steps (six pitches)	Ultimate tensile strength	Average tensile strength	Weight per step
	Teilung	Rollen-durchmesser	Innere Breite	Bolzen-durchmesser	Bolzen-länge		Buchsen-durchmesser		Buchsen-länge		Laschen-abmessungen		Abstand zwischen Stufen (6 Teilungen)	Min. Bruchkraft	Durchschn. Bruchkraft	Gewicht pro Stufe
	P	d1 max	b1 min	d2	L max	Lc max	d3	d4	L1 max	h2 max	t/T	Le	Q min	Q0	q	
	mm	mm	mm	mm	mm	mm	mm	mm	mm	mm	mm	mm	mm	kN/LB	kN	kg
C-13T	68.40	32.0	20.6	14.29	45.0	50.85	23.5	28.5	40.85	38.5	4.8	410.4	127.4/28640	140.0	2.30	
P67-FD	67.73	28.5	27.0	14.29	52.3	57.00	23.0	27.0	36.85	38.0	4.8	406.4	130.0/299225	140.0	2.19	
C-16V	68.40	28.0	29.6	14.29	53.9	59.60	22.0	26	29.35	39.6	4.8	410.4	161.7/36351	178.0	2.38	
C-12V	68.40	28.0	20.7	12.70	41.9	47.40	21.0	26	30.50	39.6	4.0	410.4	140.0/31473	154.0	1.82	
C-8V	68.40	28.0	20.7	12.70	41.9	47.40	21.0	26	30.50	39.6	4.0	410.4	100.0/224809	110.0	1.82	
ST67HF2	67.73	28.5	27.0	14.63	52.7	57.00	23.0	27	36.85	40.0	4.8/5.5	406.4	186.2/41859	204.0	2.31	
ST67HF1	67.73	28.5	27.0	14.63	52.7	57.00	23.0	27	36.85	40.0	4.8/5.5	406.4	160.0/35969	176.0	2.31	

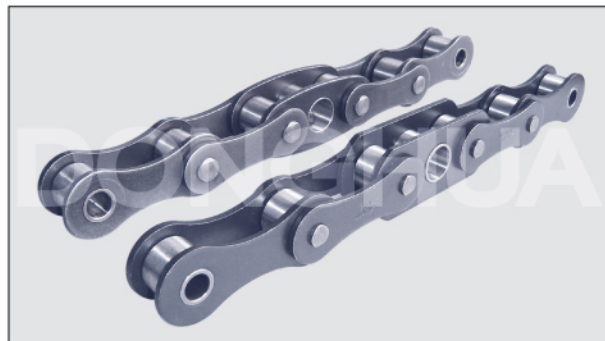

Escalator step-chains

Fahrtreppenketten

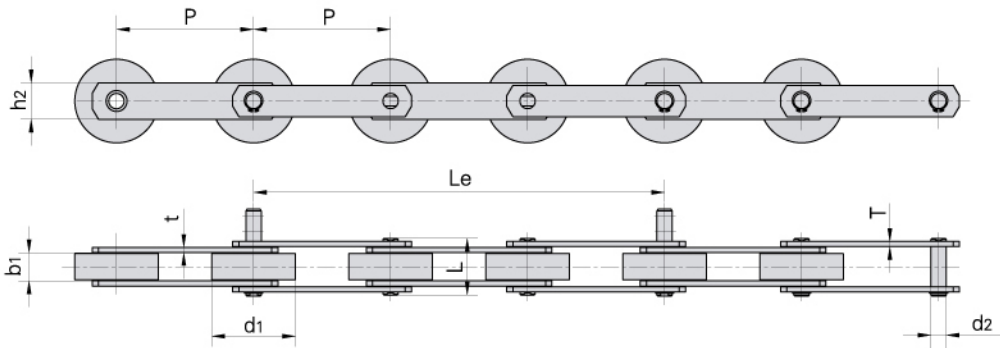

Donghua Chain No. Donghua Ketten Nr.	Pitch	Roller diameter	Width between inner plates	Pin diameter	Pin length	Inner plate depth	Plate thickness	Distance between steps (three pitches)	Ultimate tensile strength	Average tensile strength	Weight per step
	Teilung	Rollen-durchmesser	Innere Breite	Bolzen-durchmesser	Bolzen-länge	Innen-laschen-höhe	Laschen-dicke	Abstand zwischen Stufen (3 Teilungen)	Min. Bruchkraft	Durchschn. Bruchkraft	Gewicht pro Stufe
	P mm	d1 max mm	b1 min mm	d2 max mm	L max mm	h2 mm	t/T max mm	Le mm	Q min kN/LB	Q0 kN	q kg
ST131	131.33	80.00	27.0	24.00	54.5	50.0	5.0	394.00	180.0/40465	198.0	3.70
T131	131.33	80.00	27.0	14.63	54.5	50.0	5.0	394.00	180.0/40465	198.0	2.48
JJT131	131.33	80.00	27.0	14.63	56.5	35.0	5.0	394.00	123.0/27651	150.0	2.31
ST133	133.33	70.00	27.0	14.63	55.0	40.0	5.0	400.00	180.0/40465	198.0	2.45
JJT133	133.33	70.00	27.0	14.63	56.5	35.0	5.0	400.00	127.4/28640	140.1	2.38
ST133F1	133.33	80.00	27.0	24.00	54.5	50.0	5.0	400.00	180.0/40465	198.0	3.53
ST133F3	133.33	75.00	25.4	14.63	54.2	35.0	5.0	400.00	123/27651	135.3	2.16
ST133F4	133.33	76.20	27.0	14.63	55.0	40.0	5.0	400.00	180/40465	198.0	2.50
ST133F5	133.33	39.37	33.7	22.00	70.0	60.0	7.0/6.0	400.00	350/78683	385.0	4.78
ST133F6	133.33	39.37	33.7	16.00	65.0	50.0	5.0	400.00	170/38217	187.0	3.36
JJT131F1	131.33	76.20	23.6	12.70	52.0	35.0	5.0	394.00	90/20232	99.0	2.05
JJT131F2	131.33	76.20	23.6	12.70	52.0	35.0	5.0	394.00	90/20232	99.0	2.05
JJT131F3	131.33	76.20	23.6	15.00	52.0	35.0	5.0	394.00	123/27651	135.3	2.20
JJT131F4	131.33	76.20	23.6	15.00	52.0	35.0	5.0	394.00	123/27651	135.3	2.20
ST135F2	135.47	76.20	23.6	12.7/15	54.2	35.0	5.0	406.40	90/20232	99.0	2.05



Escalator step-chains Fahrtreppenketten

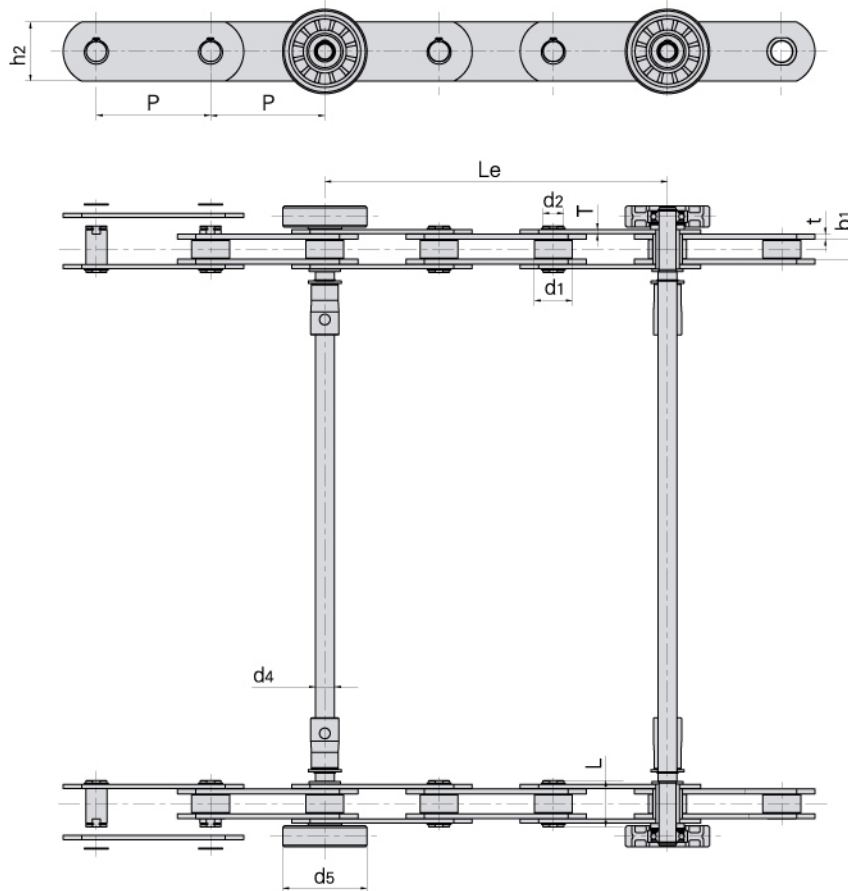

Donghua Chain No. Donghua Ketten Nr.	Pitch	Roller diameter	Width between inner plates	Pin diameter	Pin length	Inner plate depth	Plate thickness	Distance between steps (three pitches)	Axle diameter	Bearing roller diameter	Ultimate tensile strength
	Teilung	Rollen-durchmesser	Innere Breite	Bolzen-durchmesser	Bolzen-länge	Innen-laschen-höhe	Laschen-dicke	Abstand zwischen Stufen (3 Teilungen)	Stufenbolzen-durchmesser	Laufrollen-durchmesser	Min. Bruchkraft
	P	d1	b1	d2	L	h2	t/T	Le	d4	d5	Q _{min}
	mm	mm	mm	mm	mm	mm	mm	mm	mm	mm	kN/LB
PT135HPF4	135.466	45	23.5	25	55	70	6.0/5.0	406.4	22.226	100	250/56240

Escalator step-chains Fahrtreppenketten

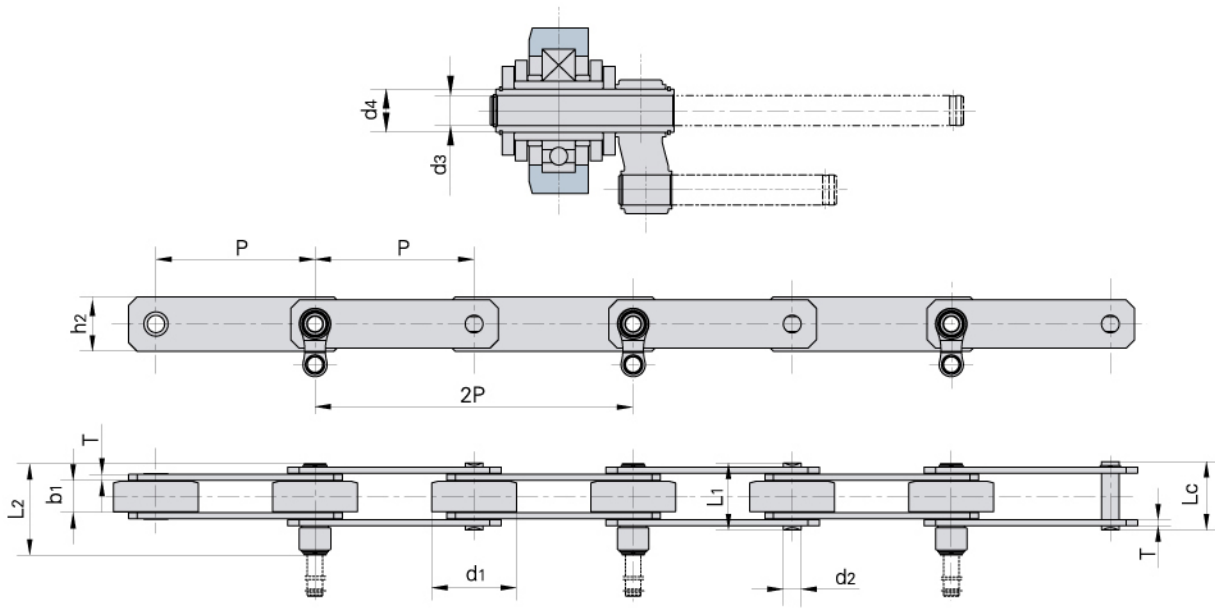

Donghua Chain No. Donghua Ketten Nr.	Pitch	Roller diameter	Width between inner plates	Pin diameter	(Hollow) Pin diameter		Pin length			Plate dimension		Ultimate tensile strength	Average tensile strength	Weight per meter
	Teilung	Rollen-durchmesser	Innere Breite	Bolzen-durchmesser	Hohlbolzen-durchmesser	Hohlbolzen-durchmesser	Bolzen-länge			Laschen-abmessungen		Min. Bruchkraft	Durchschn. Bruchkraft	Gewicht
	P	d1 max	b1 min	d2 max	d3 min	d4 max	L1 max	L2 max	Lc max	h2 max	T max	Q min	Q0	q
	mm	mm	mm	mm	mm	mm	mm	mm	mm	mm	mm	kN/LB	kN	kg/m
PT131HP	131.33	70.0	27.0	14.63	12.7	18.26	55.0	75.3	56.0	40.0	5.0	150.0/34089	165.0	7.53

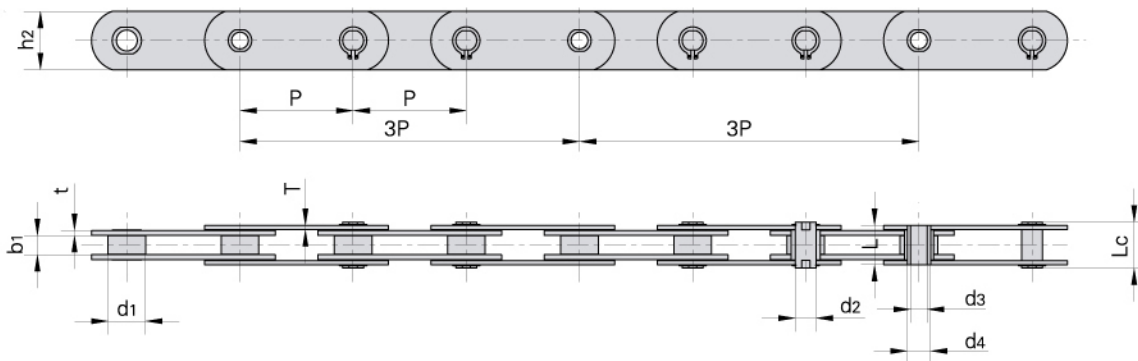

Donghua Chain No. Donghua Ketten Nr.	Pitch	Roller diameter	Width between inner plates	Pin diameter	(Hollow) Pin diameter		Pin length		Plate dimension		Ultimate tensile strength	Average tensile strength	Weight per meter
	Teilung	Rollen-durchmesser	Innere Breite	Bolzen-durchmesser	Hohlbolzen-durchmesser	Hohlbolzen-durchmesser	Bolzen-länge		Laschen-abmessungen		Min. Bruchkraft	Durchschn. Bruchkraft	Gewicht
	P	d1 max	b1 min	d2 max	d3 min	d4 max	L max	Lc max	h2	t/T max	Q min	Q0	q
	mm	mm	mm	mm	mm	mm	mm	mm	mm	mm	kN/LB	kN	kg/m
PT135HP	135.46	45.0	23.0	25.0	20.0	28.0	47.1	55.1	70.0	6.0/5.0	250.0/56818	275.0	11.26

Escalator step-chains Fahrtreppenketten

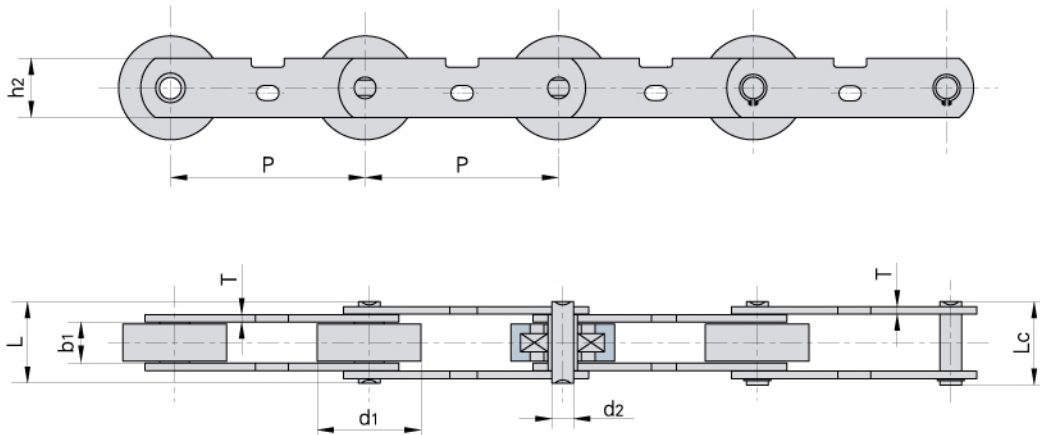

Donghua Chain No. Donghua Ketten Nr.	Pitch	Roller diameter	Width between inner plates	Pin diameter	Pin length		Inner plate depth	Plate thickness	Ultimate tensile strength	Average tensile strength	Weight per meter
	Teilung	Rollen-durchmesser	Innere Breite	Bolzen-durchmesser	L	Lc	Innen-laschen-höhe	Laschen-dicke	Min. Bruchkraft	Durchschn. Bruchkraft	Gewicht
	P	d1 max	b1 min	d2 max	L max	Lc max	h2 max	T max	Q min	Q0	q
	mm	mm	mm	mm	mm	mm	mm	mm	kN/LB	kN	kg/m
PT131	131.33	70.0	27.0	14.63	55.0	56.0	40.0	5.0	180.0/40909	198.0	5.97
PT133	133.33	70.0	27.0	14.63	55.0	56.0	40.0	5.0	180.0/40909	198.0	5.75

