

Conveyor chains for crawler asphalt paver

Förderketten für den Straßenbau

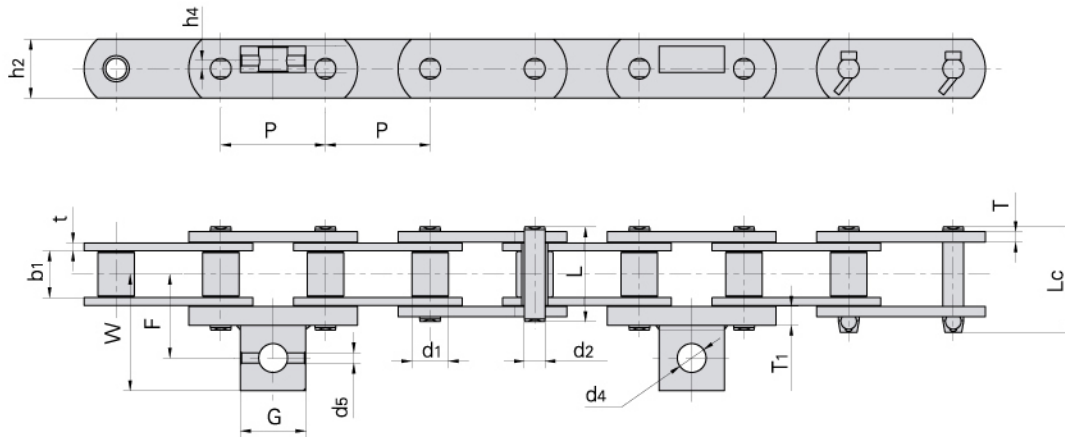

Donghua Chain No. Donghua Ketten Nr.	P	F	W	G	h4	d4	d5	T1
	mm	mm	mm	mm	mm	mm	mm	mm
P80F7	80.0	56.4	81.4	50.5	5.0	21.0	8.2	6.2
P80F8	80.0	63.0	88.0	50.0	2.0	22.0	10.2	14.2
P80F17	80.0	66.3	91.3	50.0	7.5	24.0	-	15.0
P80F19	80.0	56.5	81.5	50.0	2.8	22.0	8.0	20.0
P80F21	80.0	57.0	82.0	50.0	7.0	21.5	-	15.0

Donghua Chain No. Donghua Ketten Nr.	Pitch	Roller diameter	Width between inner plates	Pin diameter	Pin length		Plate depth	Plate thickness	Ultimate tensile strength	Weight per meter
	Teilung	Rollen-durchmesser	Innere Breite	Bolzen-durchmesser	Bolzen-länge		Laschen-höhe	Laschen-dicke	Min. Bruchkraft	Gewicht
	P	d1 max	b1 min	d2 max	L max	Lc max	h2 max	t/T max	Q min	q
	mm	mm	mm	mm	mm	mm	mm	mm	kN/LB	kg/m
P80F7	80.0	35.76	35.3	18.00	72.0	76.7	46.00	7.0/6.2	95.0/21370	11.91
P80F8	80.0	27.94	33.8	15.90	68.4	76.0	44.45	6.0/8.0	190.0/42741	10.80
P80F17	80.0	36.00	35.3	18.00	81.0	81.5	45.00	6.0/5.0	195.0/43866	12.90
P80F19	80.0	27.94	33.8	15.90	68.4	75.8	45.00	6.0/8.0	190.0/42741	11.20
P80F21	80.0	27.94	34.0	15.90	78.4	-	45.00	6.0/8.0	190.0/42741	10.70

Conveyor chains for crawler asphalt paver

Förderketten für den Straßenbau

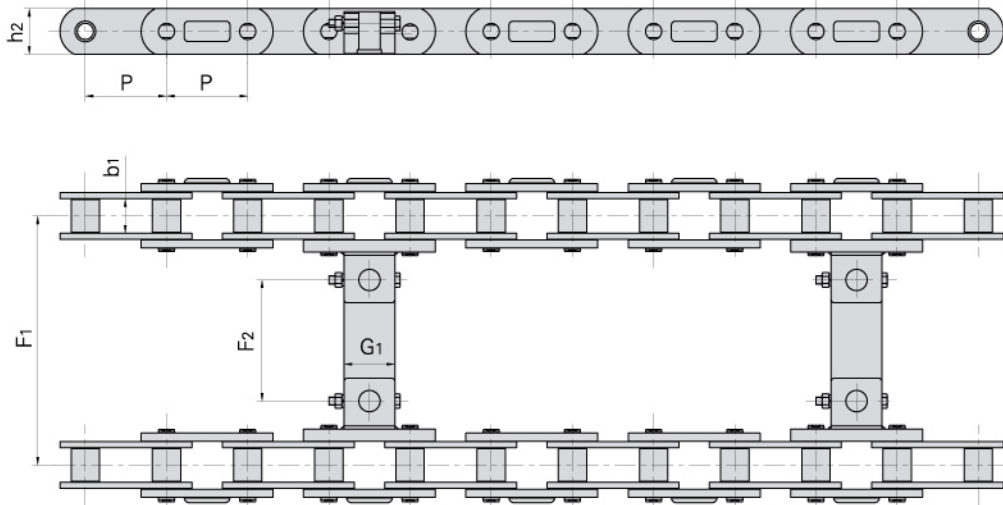

Donghua Chain No. Donghua Ketten Nr.	P	b1	h2	F1	F2	G1
	mm	mm	mm	mm	mm	mm
P80F8	80.0	33.8	45.0	575.0	449.0	50.0
P80F17	80.0	35.3	45.0	575.0	442.4	50.0

